

Featuring our patented **“finger-protected”** system which helps prevent pinched fingers between section joints. Section joints have a dual seal system to ensure a tight fit and reduce airflow. This is one of the many standard safety features of this product.

## Enjoy these Advantages

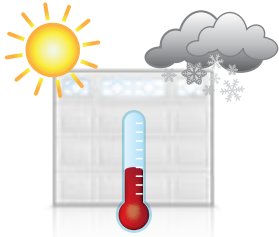

### Weather the Ontario Climate.

Built to withstand year round weather conditions, our doors have a continuous polyurethane insulated core, arctic-grade bottom seal, dual-seal section joints and double-fin perimeter weather-strip to help reduce air flow and lower your energy costs.

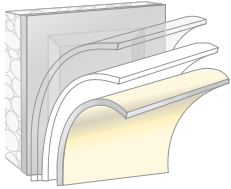

### Built to last.

Door sections are constructed from high-strength, rust-resistant galvanized steel coated with a baked-on polyester paint finish, ensuring a durable and long-lasting door.



### Green comes standard.

Our "Neufoam" polyurethane insulation is zero ozone-depleting to help reduce greenhouse gas emissions. Woodgrain embossing simulates real hardwood without depleting our forests. Neufoam is the densest polyurethane in the garage door industry

## Panel Styles



Colonial

Ranch

Carriage House

Flush

## Colour Choices

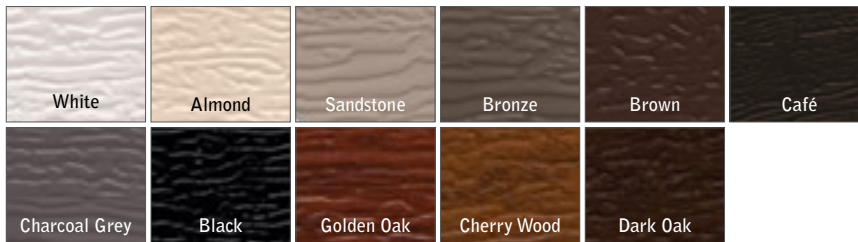

## Door Sizes



Available in a variety of standard and custom sizes.

Widths	8', 9', 10', 12', 14', 16' and 18'
Heights	6'6" to 14' in 3" increments

## Standard Window Styles

Windows are double glazed clear glass; optional clear acrylic, obscure glass (pinhead morocco) and obscure glass (glue chip). Other Options available, see your local dealer.

### Sunburst Colonial



### Sunburst Ranch



### Sherwood Colonial



### Stockton Colonial



### Stockton Ranch



### Arched Stockton Ranch



### Cascade Colonial



### Cascade Ranch



## Deluxe Window Styles

See your local dealer for additional options.

## Warranty Information

The Northland Garage Door Exclusive Warranty program can be obtained from your local dealer.

Distributed By: